



Connecting Strength

Drop N Lock Flashing w/Everseal, Kit



QUICK GUIDE

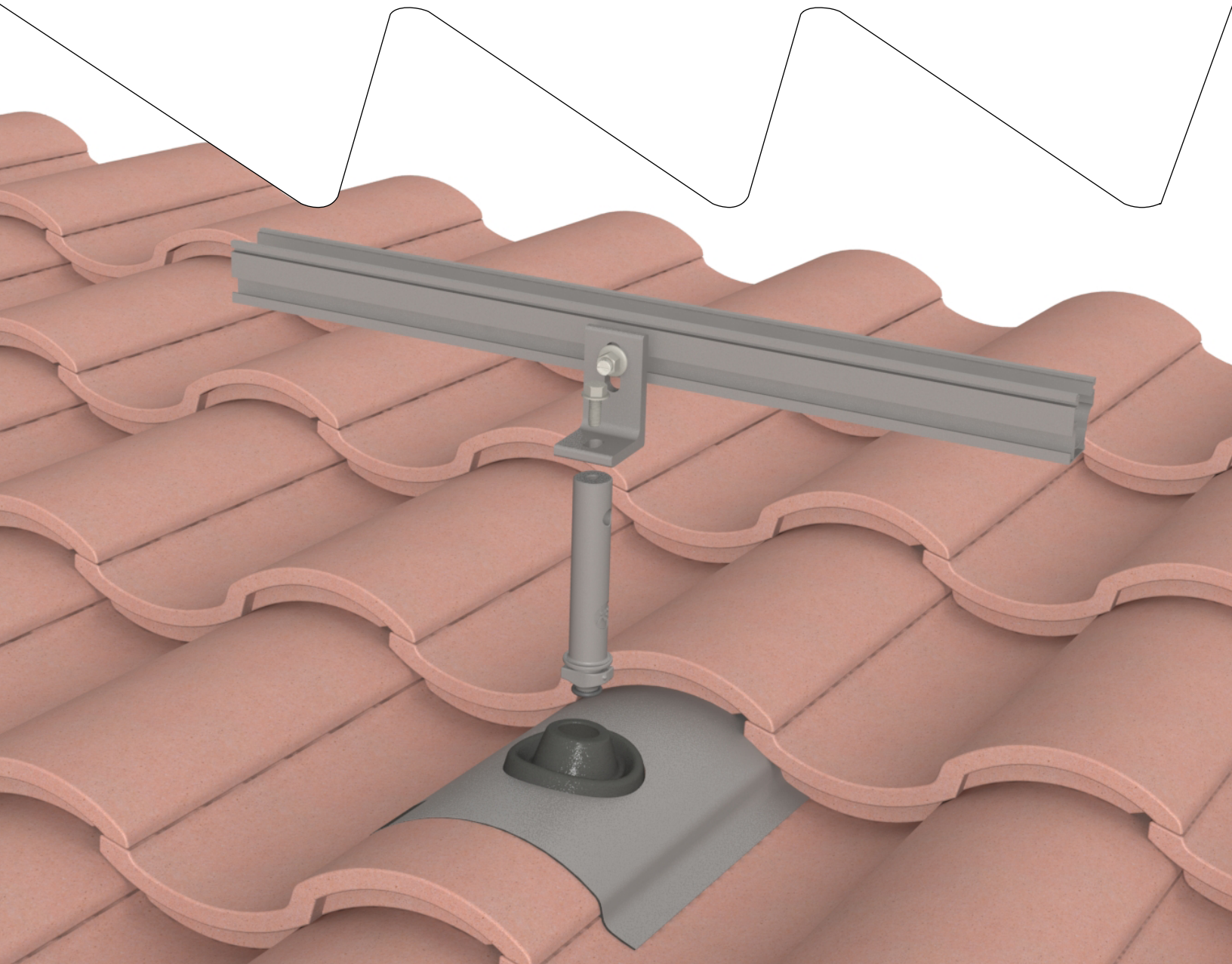

Components

- 1 4000237/4000238
K2 Drop N Lock Post 4.5", Kit
K2 Drop N Lock Post 6", Kit

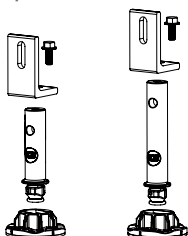

- 2 4000249-B
Drop N Lock Flashing w/Ever-seal, Kit

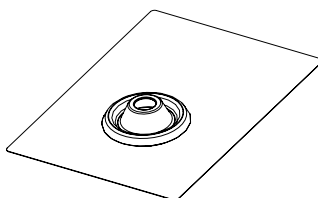

- 3 Multiple PNs
K2 Cross Clamp, 30-45 mm
module frame height

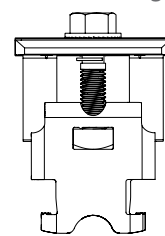

- 4 Multiple PNs
Structural Rail Connector, CR
44-X or CR 48-X/48-XL

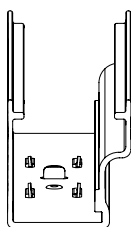

- 5 4000006-H
K2 Ground Lug

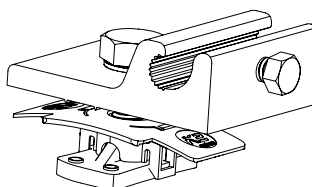

- 6 4000176, 4000431
End Cap, CR 44-X or CR
48-X/48-XL

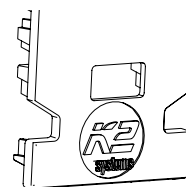

- 7 4000069, 4000382, 4005394
Wire Management: TC Wire Clip,
SunRunner Clip, Omega Clip

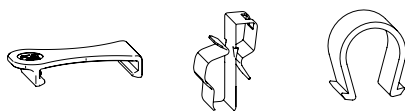

- 8 4000083, 4000629-H
MLPE Mounting Kits
MLPE Module Frame Mount,
CR Microinverter & Opt Mount Kit

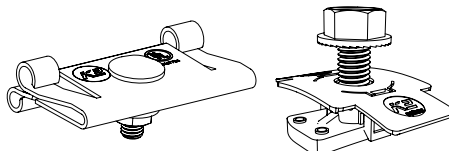

- 9 Multiple PNs
CrossRail 44-X Max, 44-X
48-X or 48-XL

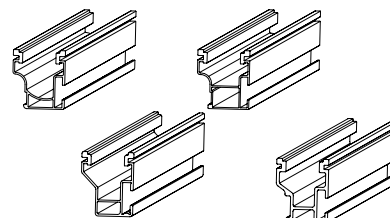

Tools Overview

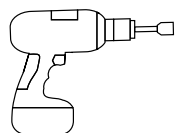

Cordless Drill



5/16"
socket



Chalk Line

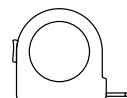

Measuring Tape

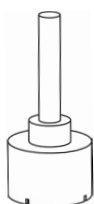

3-1/8" Diamond Hole Saw
Concrete Heavy Duty



13mm
socket

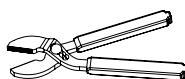

Plier Wrench



Screw Driver
(PH #2)

Assembly - Deck Attachment - Tile Drilling

1

Prepare the roof: Use a drill bit of at least 3-1/8" diameter, drill the necessary tiles to install the Universal Base. To define Universal Base locations, refer to the system engineering sheets and roof attachment span charts. Make sure to clean up the roof underlayment from any debris or dust to improve Everseal adherence.

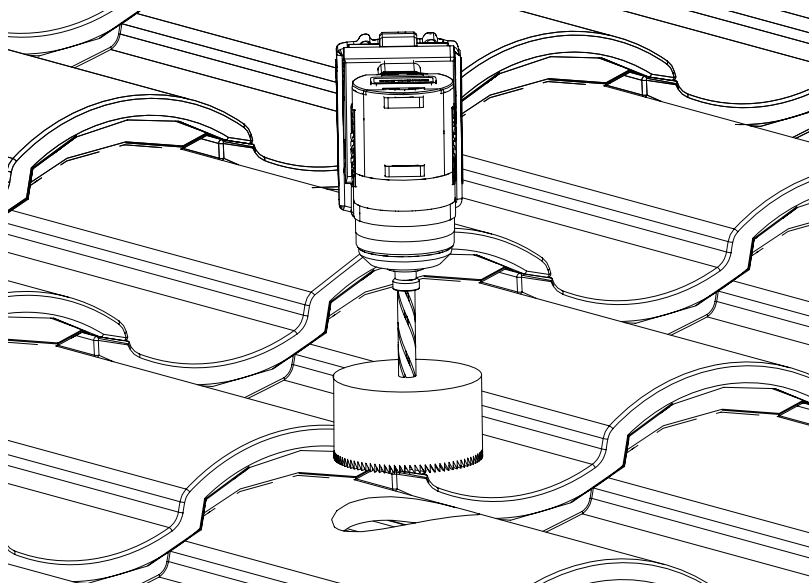

2

K2 Universal Base installation: The base has lines to identify North-South Alignment (Parallel to rafter) and East-West alignment in order to correctly position the mount for rafter or deck attachment, see image below. All the Universal Bases should be in the same orientation.

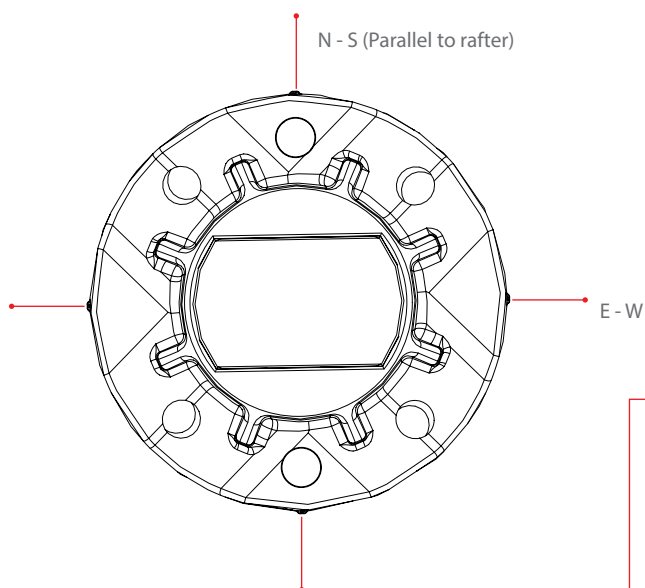

NOTE: The K2 Universal Base has 6 total screw holes. The two at the North-South location are flat and the remaining 4 holes in the base corners are slightly angled to improve the uplift performance of the mount.

3

Once the mount location is clean and prepared for installation, peel off protective paper from K2 Ever-Seal and place the mount down to the underlayment for final positioning. For deck attachments, install six of the K2 #14 screws. For rafter attachment install two of the K2 #14 screws on the north and south positioned holes. Do not overtighten. Butyl should extrude from the sides of the mount.

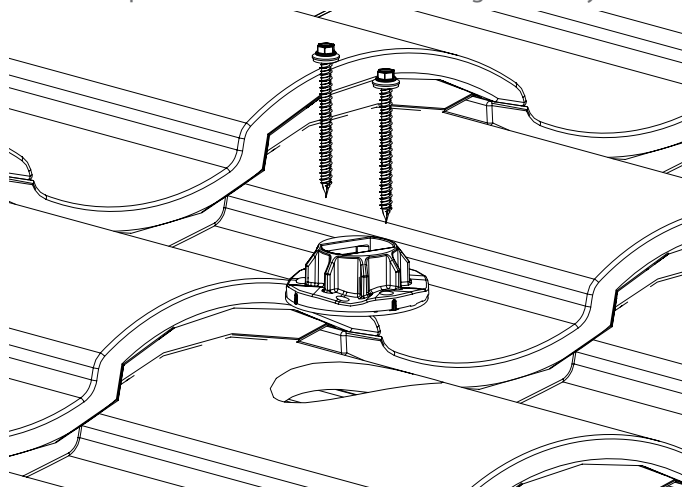

For rafter

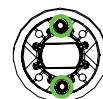

For deck attached

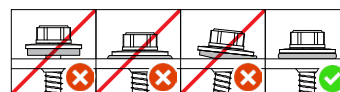
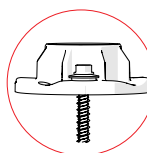

4a

! First, ensure that the EPDM cap is properly pre-installed on the bottom of the post. Insert the post into the K2 Universal Base using a pliers or screwdriver in the K2 Drop N Lock Post by rotating a quarter turn clockwise; check that the hole is oriented at the North-South direction. (this applies to both the 4.5" and 6" K2 Drop N Lock Posts).

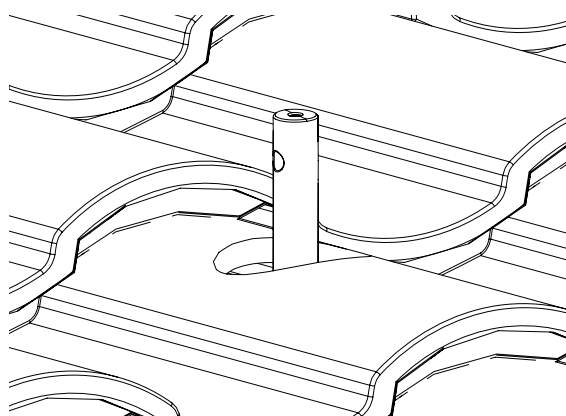
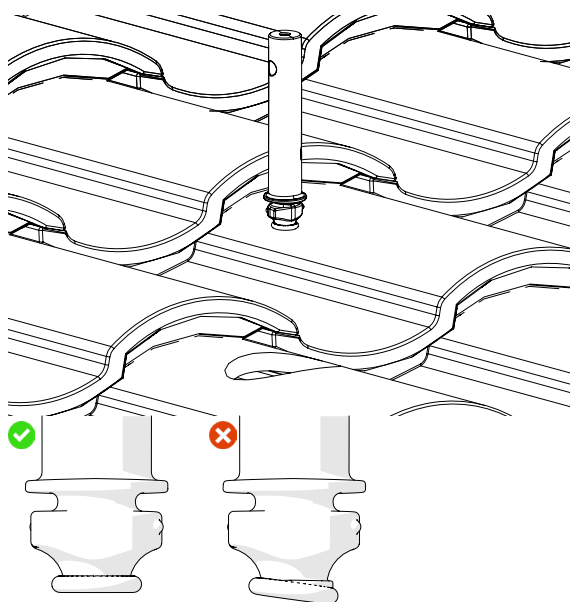

4b

Correct Drop N Lock Installation.

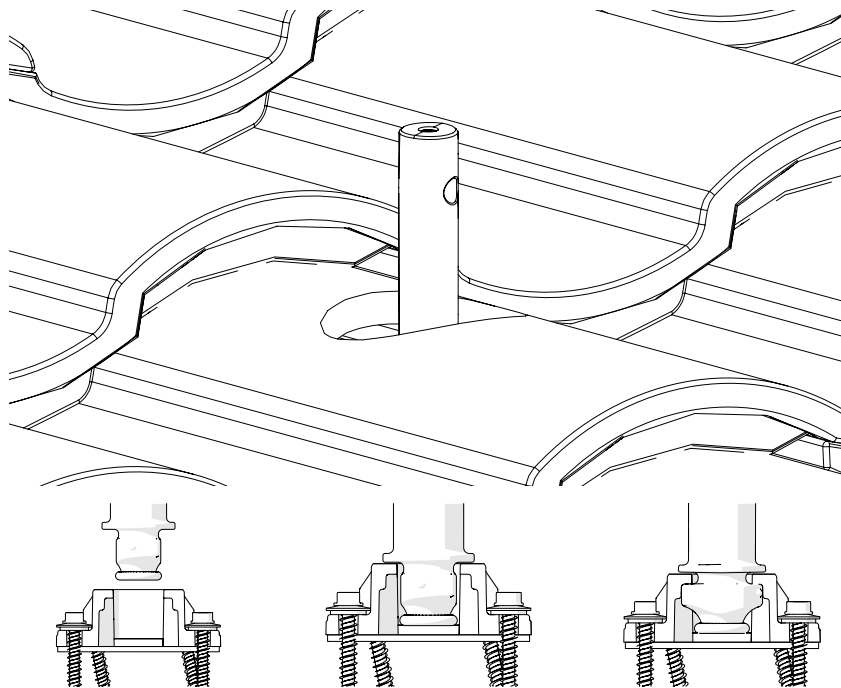

5

Make sure the surface of the tile in which you're installing the attachment is free of any dust or debris. Position Drop N Lock Flashing over post, aligning the post with the rubber collar. Slide the back of the flashing into place under the top row of tiles, placing the post through the rubber collar. Peel off protective paper from K2 Everseal and lower the flashing to the tile.

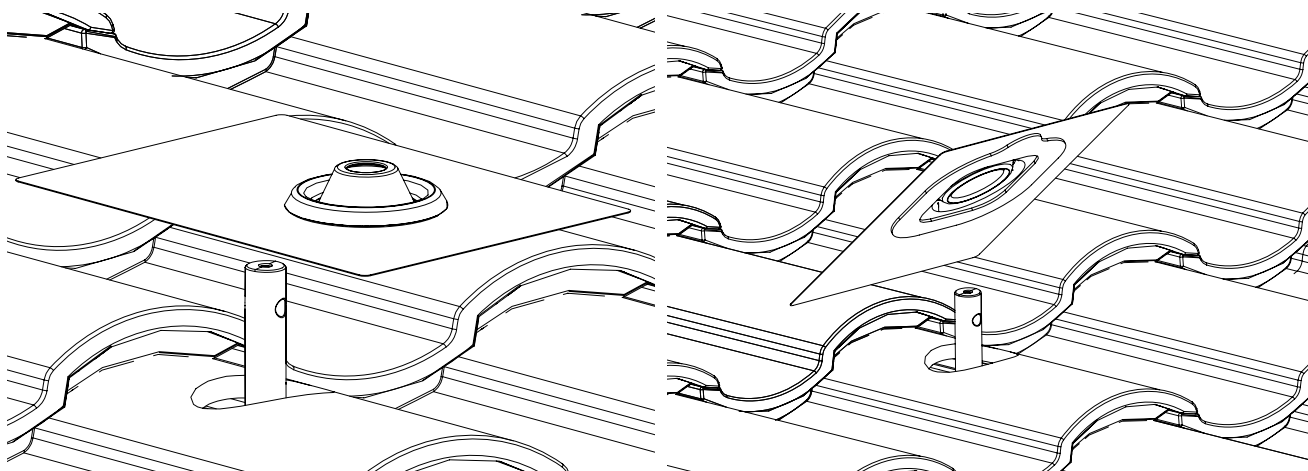

6

Mold the aluminum to match the type of tile on the roof (S-Tile, W-Tile or Flat), making sure to press firmly on the K2 Everseal section of the flashing to ensure an adequate adherence to the surface.

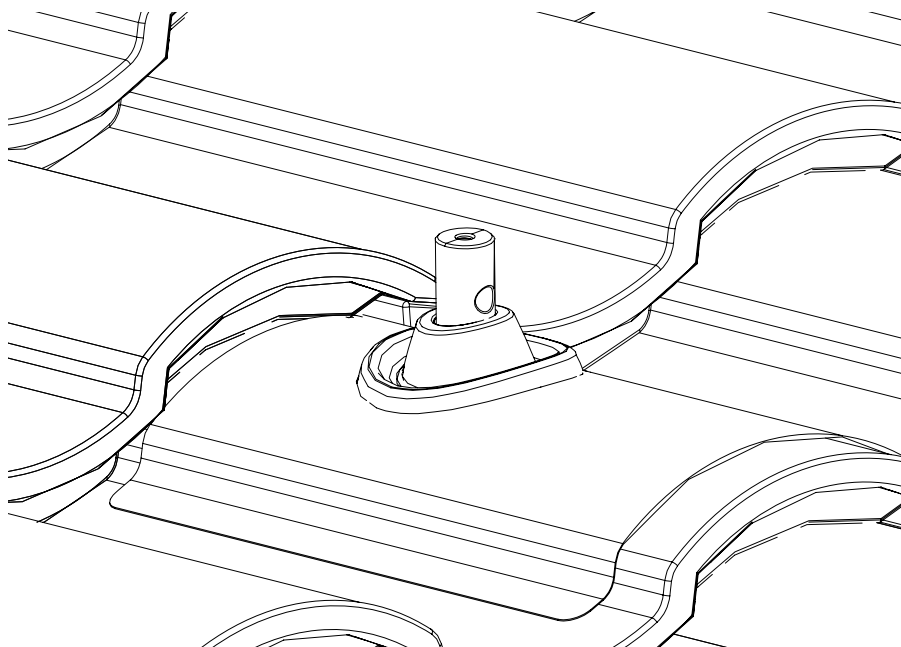

6b



When top tile is glued or cemented down and cannot be lifted to place flashing, install flashing by turning it 180° to avoid any overlap. Press down over all the flashing surface to mold it to the tile. K2 Everseal will work as a 360° barrier against water

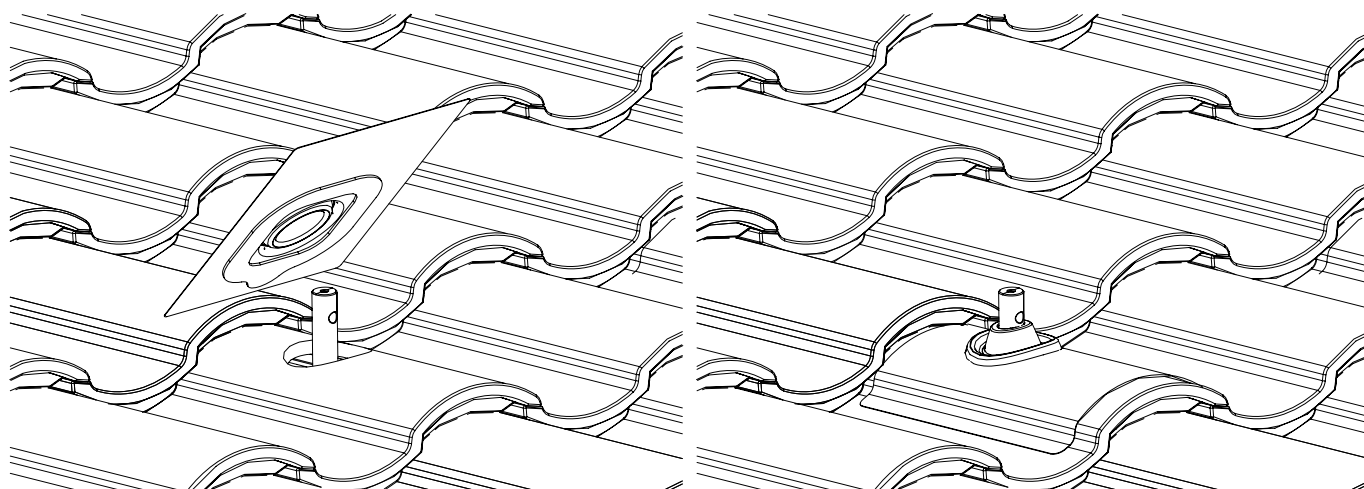

7

Install the L-Foot above the post and tighten the M8 screw into the threaded hole. Torque the M8 screw to 12ft-lbs (16Nm).

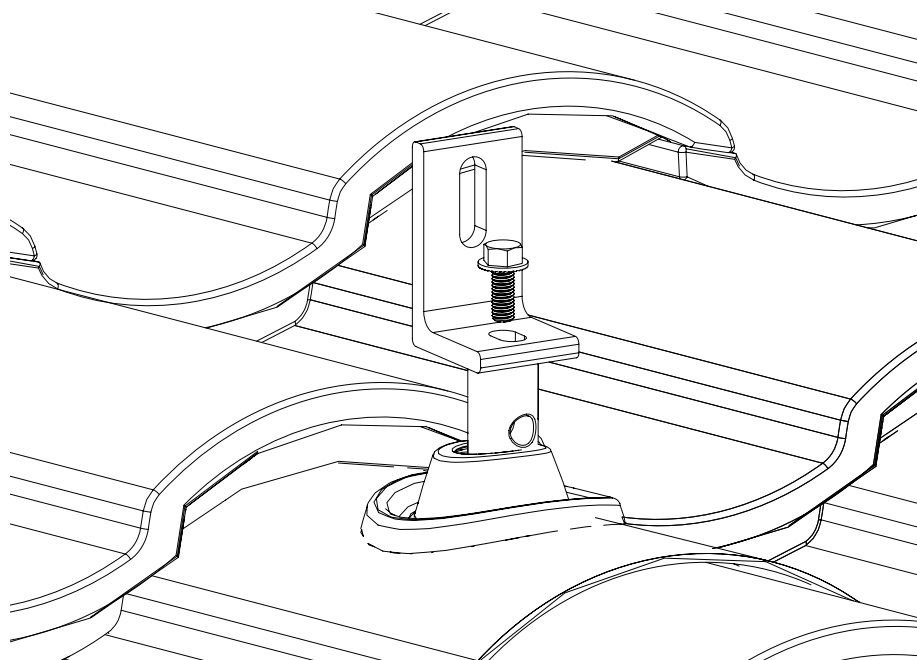

8

Repeat steps at each of the tiles positions where the mount will be installed.
Done!

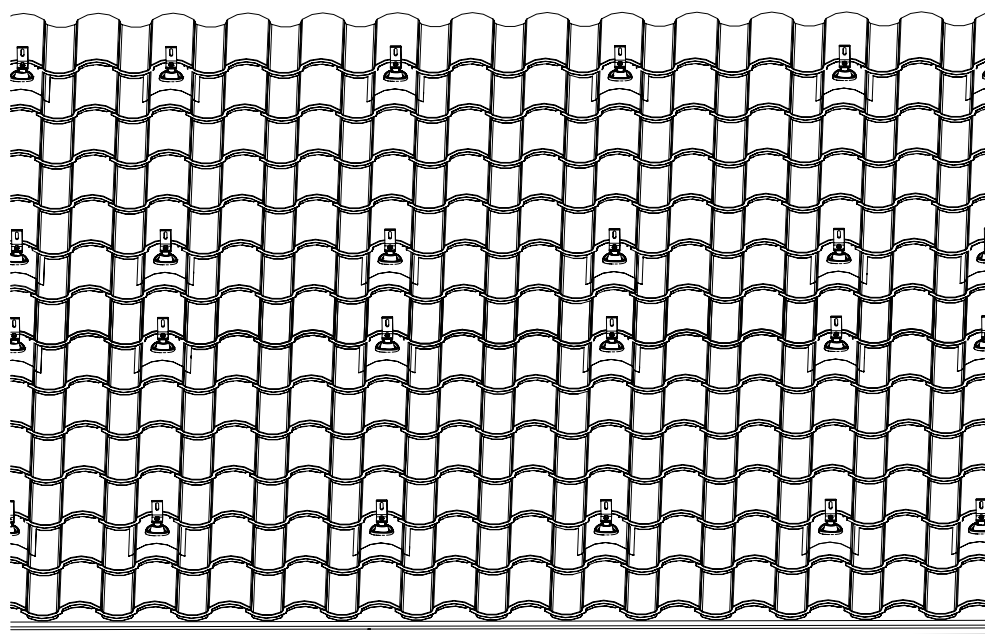

Alternative install: Cemented Tiles

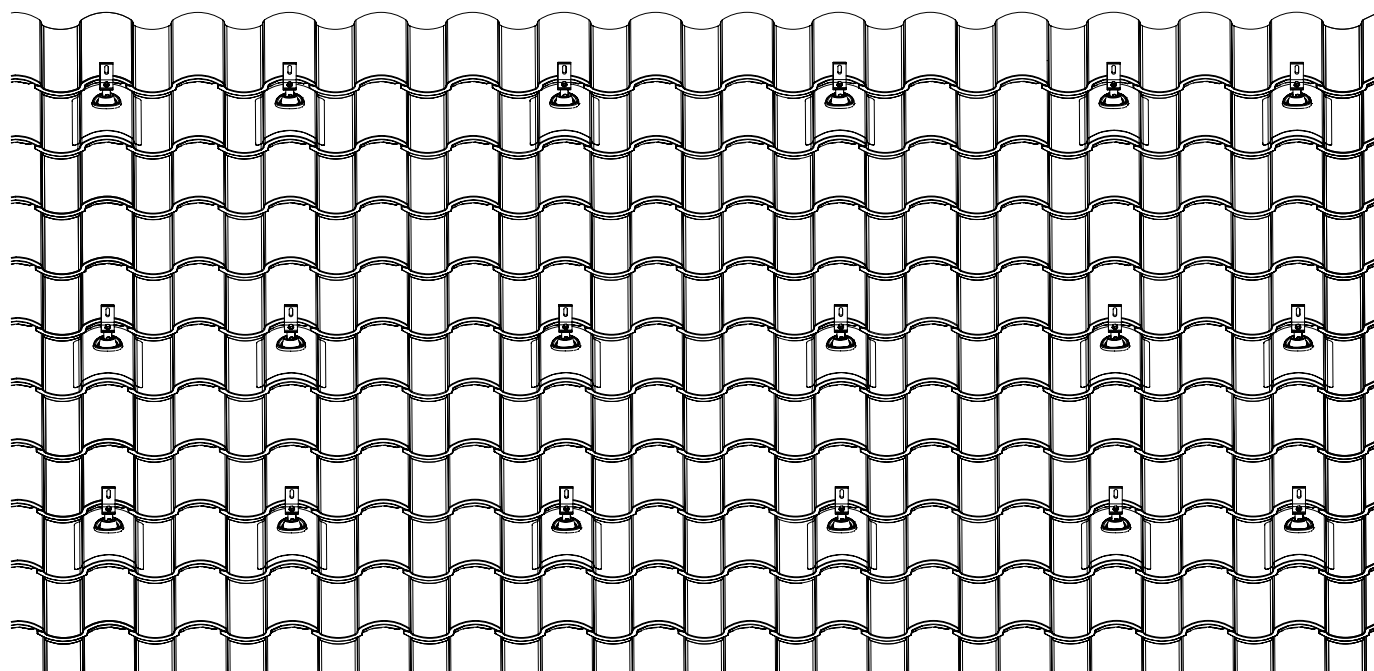

Notes



Notes





Connecting Strength

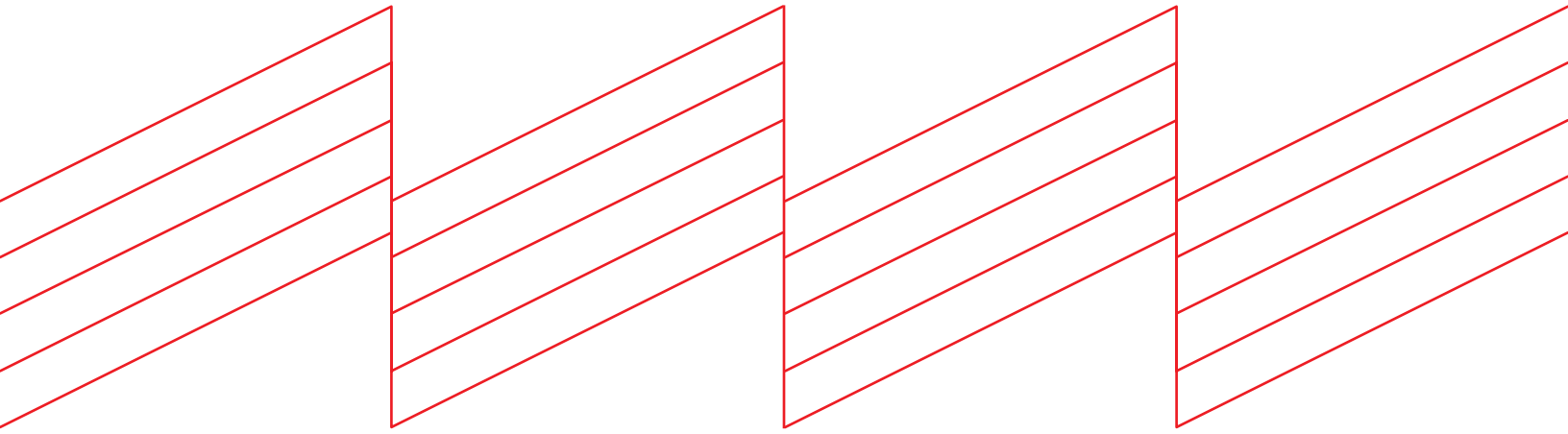

K2 Systems, LLC
4665 North Ave. Suite I • Oceanside, CA 92056•
USA +1.760.301.5300 • info@k2-systems.com
www.k2-systems.com/en.us

Drop N Lock Flashing w/Everseal, Kit • Quick Guide V1 | 0825 • Subject to change
Product illustrations are exemplary and may differ from the original.