

USH +2, 5.5, W/K2 EverSeal & Runner

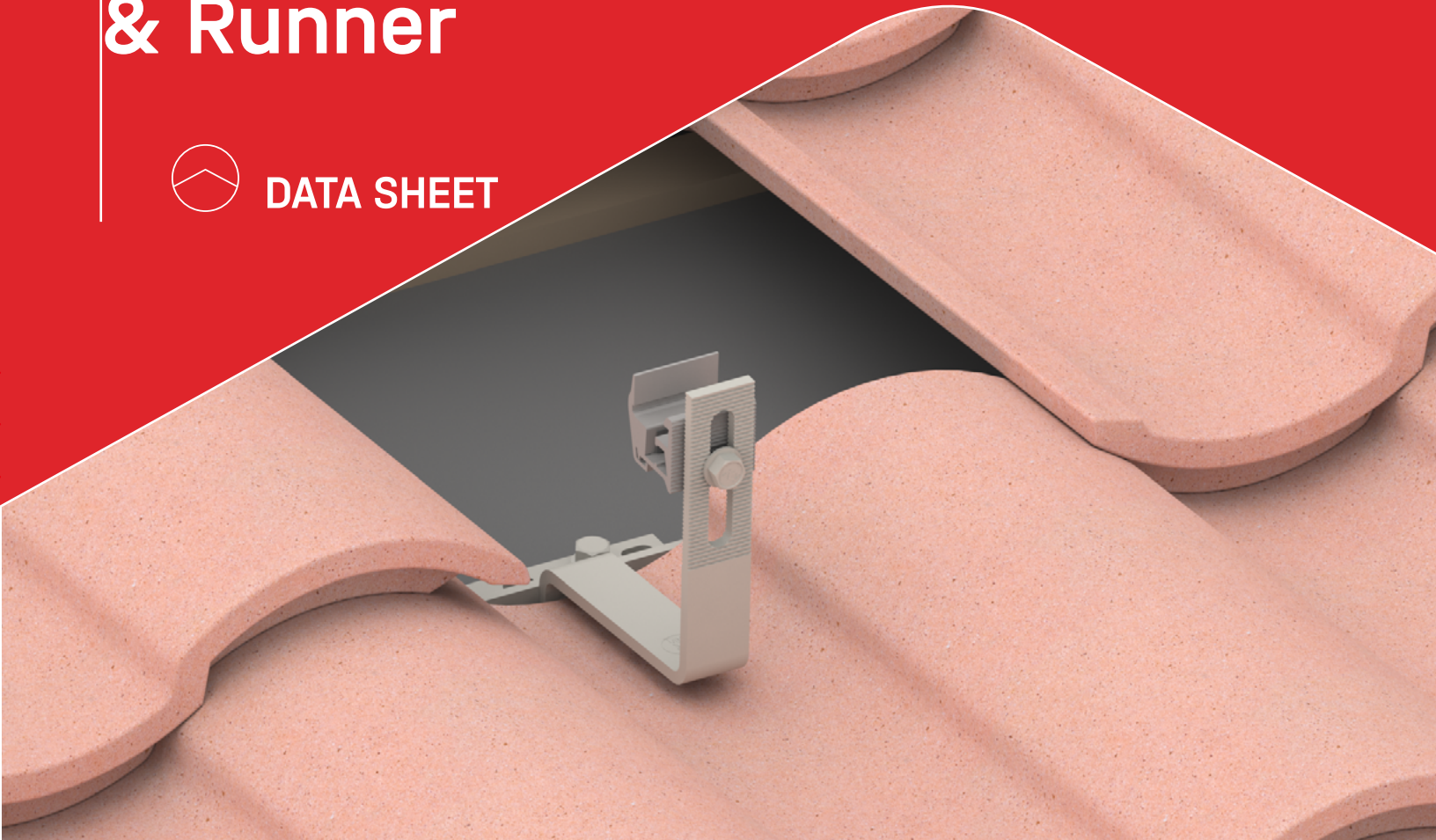

DATA SHEET



PRODUCT FEATURES

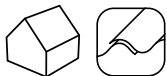

- / K2 EverSeal pre-assembled on the base
- / Universal hook with maximum adjustability
- / Slim design reduces Tile interference
- / No additional sealant required
- / Compatible with EverFlash Flat, W, S and K2 Tile Hood Flashings
- / Not T-bolt: pre-assembled with K2 Rail Runner is to support your rail easy and provide maximum engagement

TECHNICAL DATA

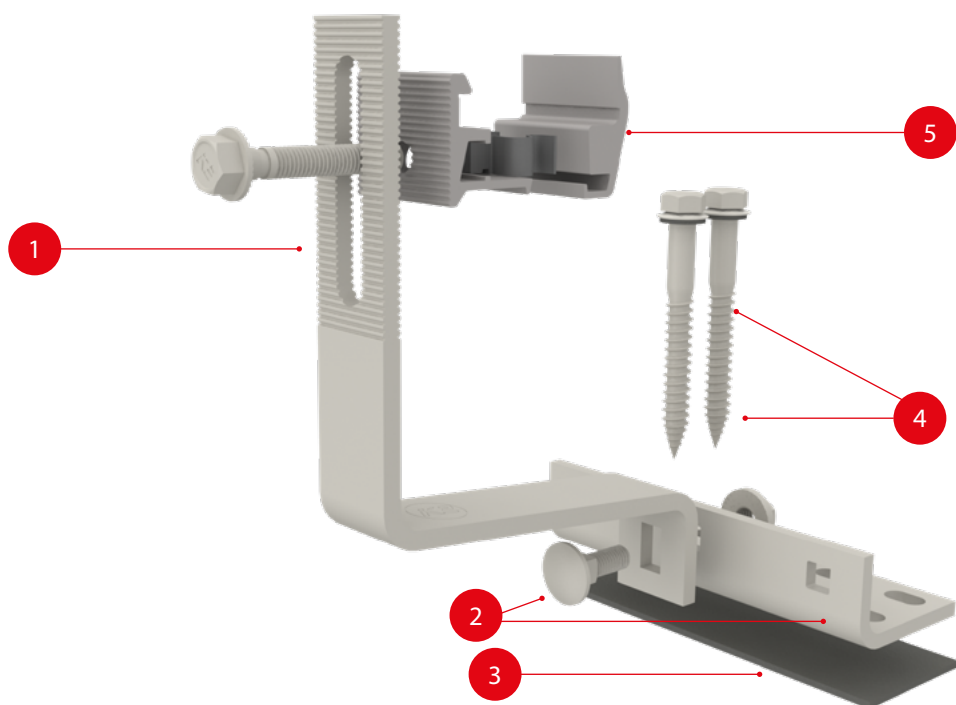

Item No.	Description	Part Number
1	Universal Standard Hook +2, Top	4000142-BR USH +2, 5.5", w/K2 EverSeal, Runner
2	Universal Standard Hook +2, 5.5" Base w/ Hardware	
3	K2 EverSeal	
4	5/16" Lag Screws w/ EDPM Washers	
5	K2 Rail Runner, Kit	

	Universal Standard Hook +2, 5.5" Base Kit
Roof Type	All tile roof types
Material	Stainless steel and 6000 series aluminium
Finish	Mill
Roof Connection	5/16" Lag Screws w/ EDPM Washers
Compatibility	CrossRail 44-X, 44-X Max, 48-X, 48-XL

Units: [mm] in

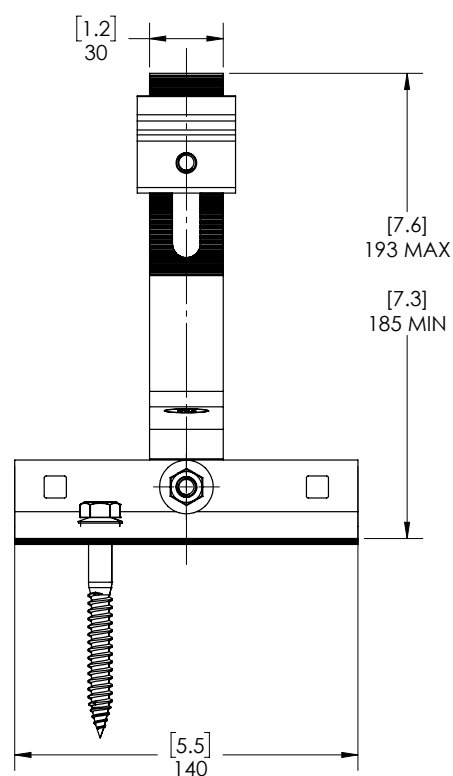
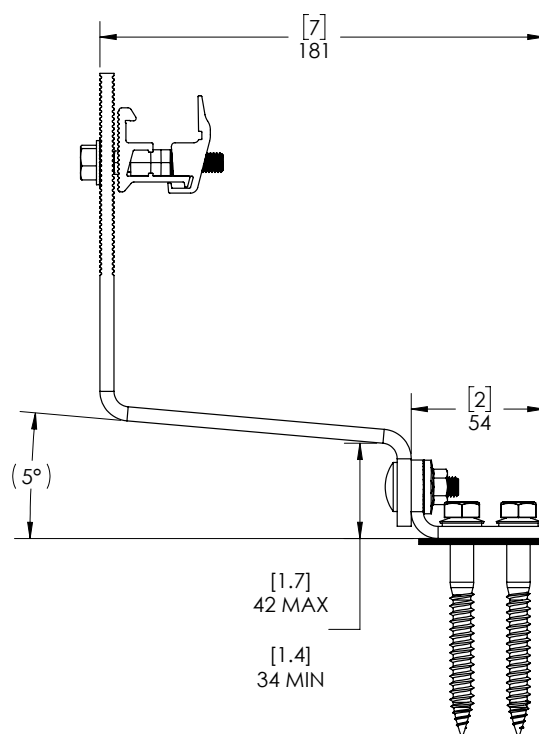



Connecting Strength

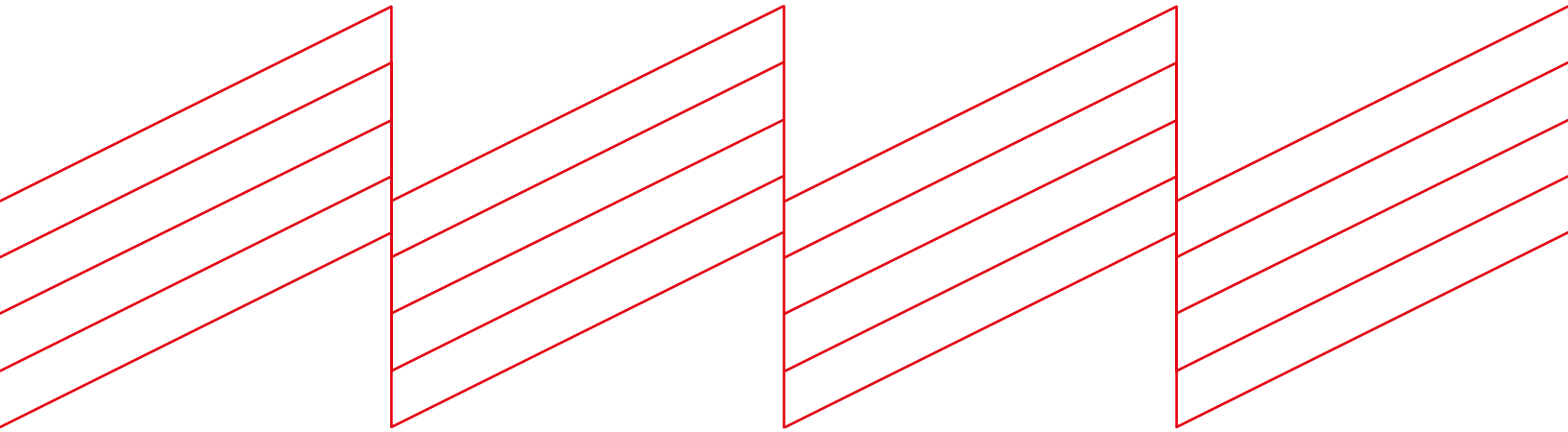

K2 Systems, LLC

4665 North Ave. Suite I • Oceanside, CA 92056 •
USA +1.760.301.5300 • infous@k2-systems.com
www.k2-systems.com/en-us

USH +2, 5.5", w/K2 EverSeal, Runner DS ENV1 | 0625 • Subject to change
Product illustrations are exemplary and may differ from the original.